

UCHUANG

普创机械



*Promoting Craftsmanship*

*Creating World-Class Brand*



High Accuracy

Heavy Cutting

Low Noise

Low Vibration

Energy Saving

**PUCHUANG**  
**MACHINE CO., LTD**





CHONGQING PUCHUANG CHANGSHUN MACHINE CO.LTD



## About us

After years of development and with a production base of 20,000m<sup>2</sup> located in Chongqing City, Puchuang has grown into a professional manufacturer of surface grinding machine. We have formed a complete industrial chain which includes independent research and develop, processing, assembling, marketing and aftermarket. According to the requirement of 'high starting point, high standard, high quality and high-tech' and by optimizing enterprise internal structure, we emphasis on building up R&D center and developing new and high-tech products. With years of experience, in constantly technological innovation and through the remitting endeavor, we have continually applied invention patents with independent intellectual property rights and new practical patents, have improved the practicality and stability durability of machine. All of our machines are inspected strictly. Our soul is quality.

## Our surface grinders have six series as below:

- 1, PCA (saddle-type) series: (working area W\*L) from 200\*500mm to 500\*1000mm.
  - 2, PCD (movable column type) series: (working area W\*L) from 500\*1000mm to 1000\*4000mm.
  - 3, PCW (horizontal type) series: (working area W\*L) from 300\*680mm to 630\*1250mm.
  - 4, PCLXM (beam-type gantry grinding and milling machine) series: (working area W\*L) from 1000\*2000mm to 2000\*3000mm.
  - 5, PCLD (beam-type single-column grinding machine) series: (working area W\*L) from 800\*1600mm to 2500\*8000mm.
  - 6, PCLS (beam-type double-column gantry rail grinding machine) series: (working area W\*L) from 800\*1600mm to 2500\*8000mm.
- and customized grinding machines according to customer's requirement.

Our machines have been given credit from worldwide customers and sold to many countries such as India, Iran, Vietnam, Thailand, Philippines, Turkey, Saudi Arabia and so on. In domestic area, we have build up more than 100 marketing and service shops to provide omni-directional service. To let the user buy the rest assured that with the sweet.



# 【 CONTENT 】

Machine features .....	1
Gantry grinding machine introduction .....	2
Gantry milling and grinding machine introduction .....	3
Auto-feed system introduction .....	4
Auto cross stroke adjustment .....	5
PCA618 Precision surface grinding machine .....	6
PCA250 Precision surface grinding machine .....	7
PCA2550 Precision surface grinding machine .....	8
PCA3060 Precision surface grinding machine .....	9
PCA4080 Precision surface grinding machine .....	10
PCA40100 Precision surface grinding machine .....	11
PCA510 Precision surface grinding machine .....	12
PCD50100~50120 Precision surface grinding machine .....	13
PCD60100~60120 Precision surface grinding machine .....	14
PCD50150~70150 Precision surface grinding machine .....	15
PCD80160~80200 Precision surface grinding machine .....	16
PCD90200~100200 Precision surface grinding machine .....	17
PCD100250~100300 Precision surface grinding machine .....	18
250/3060/4080/60120CNC Precision surface grinding machine series .....	19
PCW50100~63125 horizontal-shaft precision surface grinding machine .....	20
PCW3068~40100 horizontal-shaft precision surface grinding machine .....	21
PCLD80200~90200NC Beam-type single-head gantry grinding machine .....	22
PCLD100200~120200NC Beam-type single-head gantry grinding machine .....	23
PCLD140200~150200NC Beam-type single-head gantry grinding machine .....	24
PCLD120250~150250NC Beam-type single-head gantry grinding machine .....	25
PCLD120300~150300NC Beam-type single-head gantry grinding machine .....	26
PCLD180300~200300NC Beam-type single-head gantry grinding machine .....	27
PCLD200400~200600NC Beam-type single-head gantry grinding machine .....	28
PCLD200800~250800NC Beam-type single-head gantry grinding machine .....	29
PCLXM100200~150200NC Beam-type gantry milling and grinding machine .....	30
PCLXM120250~150250NC Beam-type gantry milling and grinding machine .....	31
PCLXM120300~200300NC Beam-type gantry milling and grinding machine .....	32
PCLS80200~120200NC Beam-type double-head gantry rail grinding machine .....	33
PCLS140200~150250NC Beam-type double-head gantry rail grinding machine .....	34
PCLS120300~200300NC Beam-type double-head gantry rail grinding machine .....	35
PCLS200400~250800NC Beam-type double-head gantry rail grinding machine .....	36

# Machine Features

- 1, The machine's main castings are made of high-grade cast iron. After annealing and vibration aging treatment, the internal stress of the casting is removed, and its stability is greatly improved, which is not easy to be deformed.
2. To improve work efficiency, the machine are thick and stable to the need for machine rigidity for heavy cutting and fine grinding.
- 3, The guide rails are all attached to the advanced imported wear-resistant rubber, artificial precision shovel to ensure long-lasting precision.
- 4, The surface finish of spindle (from Taiwan) is Ra0.4. There is one more bearing and bigger size of bearing than other machines.
- 5, Precision ball screw (from Taiwan) is more lightweight, more accurate and more durable.
6. The vibration level of motor (from Taiwan) is V3. Low noise ,good quality.
- 7, The main components of hydraulic system are designed independently, with low vibration and low noise.
- 8, Creative lubricant circuit makes machine durable
- 9, Reasonable cable piping design
- 10, Lubricating oil line self-test, fault alarm, automatic circulation, fitting pressure force sensor to ensure that the guide rail is not short of oil

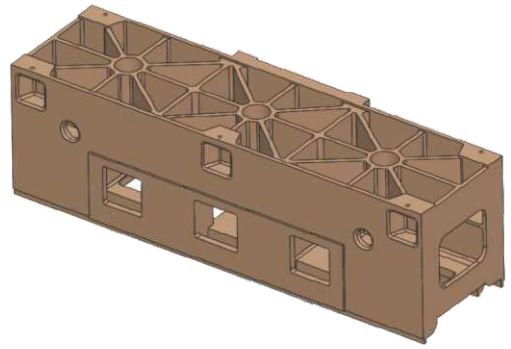



# Gantry Grinding Machine Features

## 1.High Rigidity Triangular Beam

The beam is designed with a triangular structure and has excellent high rigidity, bending resistance and torsion resistance to ensure stability. The centroid of the headstock fits firmly on the beam, so that the grinding wheel does not jump when grinding, to improve grinding efficiency and grinding accuracy.

## Guide Rails Pasted with Teflon

All the guide rails are precision ground , then manually scraping and pasted with Teflon(Taiwan) to reduce the damping coefficient for smooth working of the machine. Energy saving and efficiency increasing.

## Fully Enclosed Dust-free Guide

All the guide rails have dust cover for all-round protection, allowing dust and grinding no longer corrodes the guide rails and increases the service life .

## Precision Ball Lead Screw Drive System

Precision ball screw in Y, Z axis with gearbox drive has Self-locking and high transmission efficiency and high transmission accuracy. Electronic hand wheel to manual feed light and precise.

## Spindle and Spindle Motor

Flanged spindle with ultra-precision beveled ball bearing knot to make spindle with ultra-high grinding rigidity and grinding precision. Spindle and motor are specially customized in Taiwan, and couplings are imported from Japan and precision balancing, so that the overall vibration meet level of V3.

## Unique Lubrication System

A good lubrication system is the guarantee of the accuracy and service life of the machine. It should make sure the sufficient all-round lubrication and ensure that it does not cause waste and oil. Intermittent oiling and circulation oil system is used in the beam and guides to save fuel .

## Simple Operating Console

The well-designed gantry grinding CNC system makes the commonly used functions into buttons switch, no need to learn complicated programming, the touch screen is simple and easy to learn use. Equipped with an electronic hand wheel for easy operation.

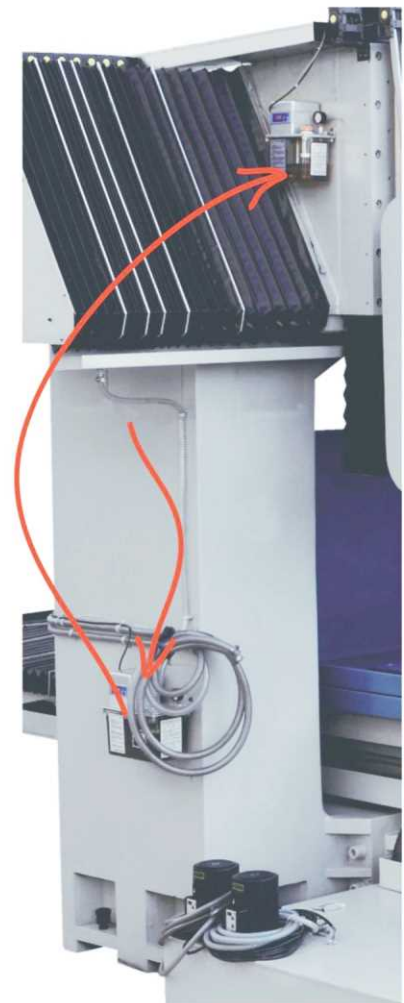
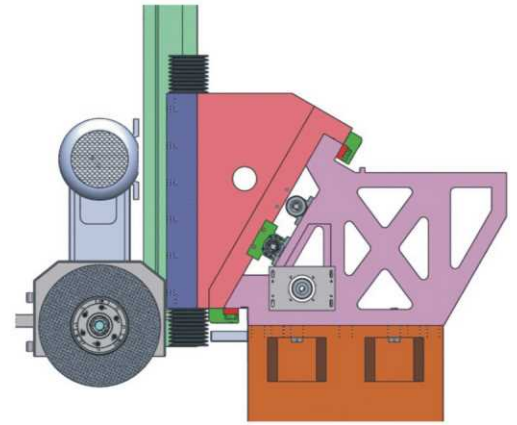

# Machine Features of Gantry Milling and Grinding Machine (Patent No. 201620172139.9)

- 1, To improve the working efficiency of plates and mold base, we have specially developed high-efficient milling and grinding machine. Due to the large traditional processing stock to leave, it takes a long time to be grinded by grinding machine, which is time-consuming, power-hungry, labor-costing. more grinding wheel consumption and so on. And also , it solve the problem of chewing up property of several machines and second clamping.
- 2, Patented-designed milling and grinding converter system, lead screw and oil cylinder converter driven worktable , ball screw driven worktable when milling which allows machine feed accurate without creeping. Oil cylinder driven worktable when grinding allows fast working and fine surface finishing.
- 3, The milling head of the machine is circularly cooled by water to ensure that the milling head can work at high speed and the tool will not overheat.
- 4, Triangle-designed cross beam is high-rigid, anti-bending, anti-twisting and stable. It allows machine head center to close firmly to cross beam and allows wheel to grind without jumping and uneasy passive. It has improved grinding efficiency and accuracy.
- 5, Dust-free cover protects all guide rails from the corrosion of dust and grinding to increase of service life.
- 6, The key to ensure machine's rail guide accuracy and service life is good lubrication system. The interval and circulating add oil system ensure overall lubrication and prevent waste and greasy dirt.

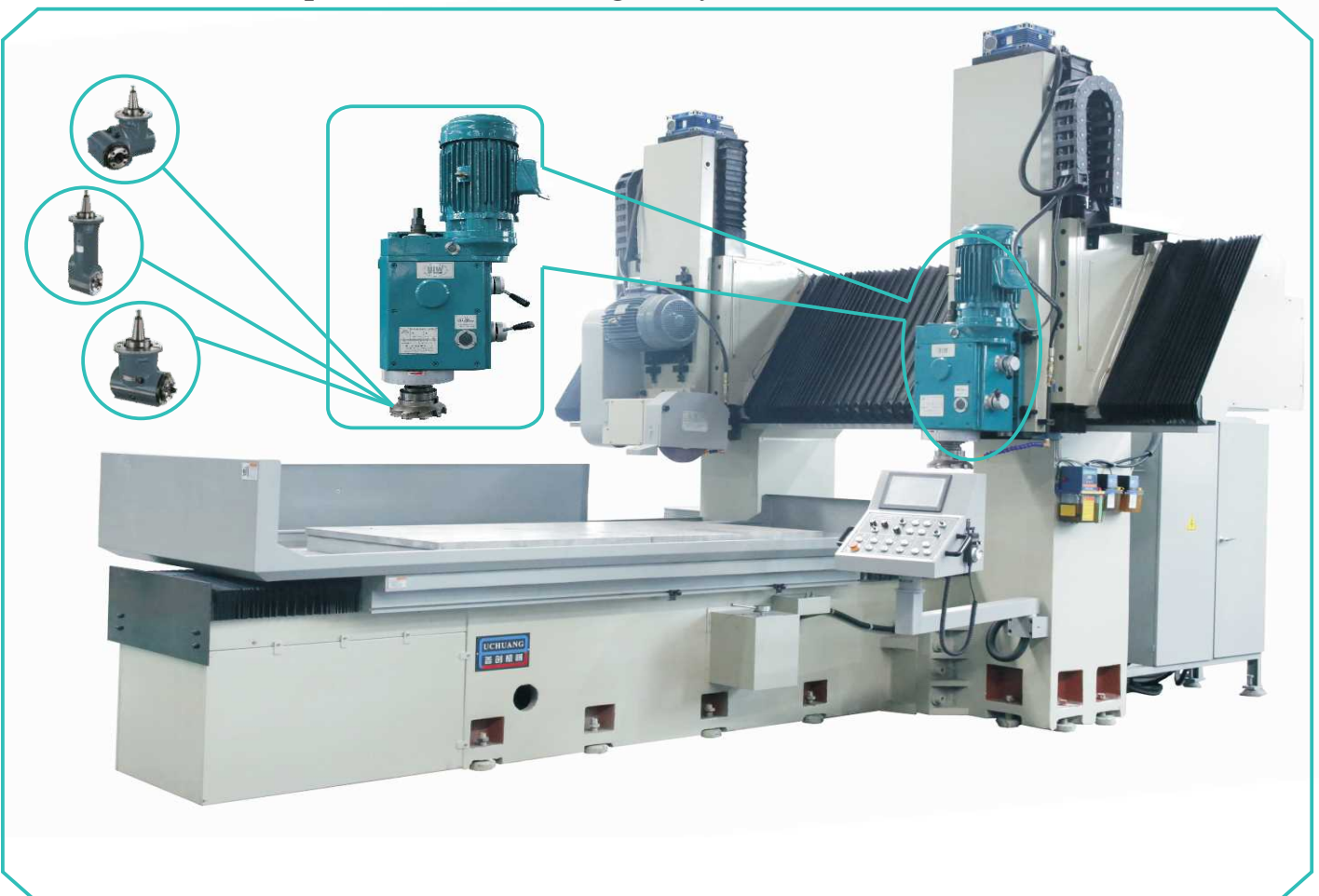



## Auto feed system

In order to save labor and improve efficiency , we have specially developed an economic and practical auto feed system..It is easy to learn , directly entering process value, with no programming required. Driven by servo motor and controlled by PLC, it could be secondly developed and add function according to customer's requirement.



## Servo system of axis

We have developed an economic and practical 2 axes servo auto feed system with no programming required and directly entering process value. The positioning of Y axis is easy, just pressing stroke setting button in the operation panel or entering value. Y axis and X axis are both driven by servo motor. In this system, the feed of rough grinding and fine grinding could be set respectively. The rough grinding and fine grinding could be finished by one setting. Controlled by PLC, this system is reliable.



## Auto Cross Stroke Adjustment

For traditional machine, the adjusting rod was installed two slide blocks to adjust cross stroke. Auto cross stroke use PLC to count. Two stroke bottoms are installed on the operating panel. Stroke setting, position memory, and cross stroke reversing could be done by one push-button.



- 
- |          |    |                                     |
|----------|----|-------------------------------------|
| 1, PCA   | —— | Saddle Grinding Machine             |
| 2, PCD   | —— | Move Column Grinding Machine        |
| 3, PCW   | —— | Horizontal Shaft Grinding Machine   |
| 4, PCLD  | —— | Single-Head Gantry Grinding Machine |
| 5, PCLS  | —— | Doudle-Head Gantry Grinding Machine |
| 6, PCLXM | —— | Gantry Milling and Grinding Machine |

For Example: PCA 3060

3060 (Working Area L\*W) 300\*600mm

AH Hydraulic Pressure in X axis, Step Motor in Y axis, Manual in Z axis

AHR Hydraulic Pressure in X axis, Step Motor in Y axis, Fast up and down in Z axis

AHD Hydraulic Pressure in X axis, Step Motor in Y axis, Servo Motor Auto-controlled in Z axis

DHD Hydraulic Pressure in X axis, Step Motor and Auto Stroke Adjustment in Y axis, Servo Motor Auto-controlled in Z axis

NC Hydraulic Pressure in X axis, Servo Motor in Y axis, Servo Motor Auto-controlled in Z axis

CNC CNC in X,Y,Z Axis



# PCA618M

## Precision Surface Grinding Machine



The picture and specification is for your reference only, all is subject to material object.

参数表	规格parameter	Unit	PCA-618M
能力 Capacity	工作台面积 Table size(x*y)	mm	150×450
	左右最大移动量 X axis travel	mm	460
	前后最大移动量 Y axis travel	mm	180
	工作台面至主轴中心最大距离 Max center of wheel to table	mm	400
	工作台最大承受重量 Maximum load	kg	80
工作台Table X axis	工作台T型槽 Table T cell specification	mm×N	14×1
	工作台速度 Table speed	m/min	manual
前后结构 Y axis	前后手轮进刀(1格/1圈) hand wheel feed degree scale	mm	0.02/5
	前后快速移动(50HZ/60HZ) Fast moving speed	mm/min	manual
砂轮 Grinding wheel	砂轮尺寸 grinding wheel size max	mm	Φ180×12.5×31.75
	砂轮转速(50HZ/60HZ) grinding wheel speed	R.P.M	2850/3360
上下结构 Z axis	上下手轮进刀(1格/1圈) hand wheel feed degree scale	mm	0.005/1
马达 Motor	主轴马达 spindle motor	H×P	1.5×2
	冲水马达 cooling motor	W	40
尺寸 Size	机床外形尺寸(长×宽×高) Machine Tool Profile Size	mm	1260×1200×1820
	重量 weight ( 约 )	kg	≈700

# PCA250 Precision surface grinding machine

## AH/AHD/NC/CNC



All-closed 250



250 with waterproof plate

The picture and specification is for your reference only, all is subject to material object.

参数表	规格parameter	Unit	PCA-250
能力 Capacity	工作台工作面积 Table size(x*y)	mm	200×500
	左右最大移动量 X axis travel	mm	600
	前后最大移动量 Y axis travel	mm	220
	工作台面至主轴中心最大距离 Max center of wheel to table	mm	480
	工作台最大承受重量 Maximum load	kg	450
工作台Table X axis	工作台T型曹 Table T cell specification	mm×N	14×1
	工作台速度 Table speed	m/min	5-25
前后结构 Y axis	前后手轮进刀(1格/1圈) hand wheel feed degree scale	mm	0.02/5
	前后自动进给 automatic feed	mm	0.1-8
	前后快速移动(50HZ/60HZ) Fast moving speed	mm/min	990 / 1190
砂轮 Grinding wheel	砂轮尺寸 grinding wheel size max	mm	Φ180×12.5×31.75
	砂轮转速(50HZ/60HZ) grinding wheel speed	R.P.M	2850 / 3360
上下结构 Z axis	上下手轮进刀(1格/1圈) hand wheel feed degree scale	mm	0.005/1
	上下快速移动速度 Fast moving speed	mm/min	-
马达 Motor	主轴马达 spindle motor	H×P	2×2
	上下驱动马达 the Z axis motor	W	-
	油压马达 hydraulic motor	H×P	1.5×6
	冲水马达 cooling motor	W	40
	前后驱动马达 the Y axis motor	W	80
尺寸 Size	机床外形尺寸(长×宽×高)Machine Tool Profile Size	mm	1750x1400x1680
	重量 weight ( 约 )	kg	≈1200



# PCA2550 Precision surface grinding machine

## AH/AHD/NC/CNC



All-closed 2550



2550 with waterproof plate

The picture and specification is for your reference only, all is subject to material object.

参数表	规格parameter	Unit	PCA-2550
能力 Capacity	工作面积 Table size(x*y)	mm	250×500
	左右最大移动量 X axis travel	mm	600
	前后最大移动量 Y axis travel	mm	280
	工作台面至主轴中心最大距离 Max center of wheel to table	mm	480
	工作台最大承受重量 Maximum load	kg	250
工作台Table X axis	工作台T型槽 Table T cell specification	mm×N	14×1
	工作台速度 Table speed	m/min	5-25
前后结构 Y axis	前后手轮进刀(1格/1圈) hand wheel feed degree scale	mm	0.02/5
	前后自动进给 automatic feed	mm	0.1-8
	前后快速移动(50HZ/60HZ) Fast moving speed	mm/min	990 / 1190
砂轮 Grinding wheel	砂轮尺寸 grinding wheel size max	mm	Φ180×12.5×31.75
	砂轮转速(50HZ/60HZ) grinding wheel speed	R.P.M	2850 / 3360
上下结构 Z axis	上下手轮进刀(1格/1圈) hand wheel feed degree scale	mm	0.005/1
	上下快速移动速度 Fast moving speed	mm/min	-
马达 Motor	主轴马达 spindle motor	H×P	2×2
	上下驱动马达 the Z axis motor	W	-
	油压马达 hydraulic motor	H×P	1.5×6
	冲水马达 cooling motor	W	40
	前后驱动马达 the Y axis motor	W	80
尺寸 Size	机床外形尺寸(长×宽×高)Machine Tool Profile Size	mm	1750x1400x1680
	重量 weight ( 约 )	kg	≈1350

# PCA3060 Precision surface grinding machine

## AHR/AHD/NC/CNC



All-closed 3060



3060 with waterproof plate

### Optional big and small grinding machine

The picture and specification is for your reference only, all is subject to material object.

参数表	规格parameter	Unit	PCA-3060 small	PCA-3060 big
能力 Capacity	工作台面积 Table size(x*y)	mm	300×600	300×600
	左右最大移动量 X axis travel	mm	720	720
	前后最大移动量 Y axis travel	mm	360	360
	工作台面至主轴中心最大距离 Max center of wheel to table	mm	605	520
	工作台最大承受重量 Maximum load	kg	600	600
工作台Table X axis	工作台T型槽 Table T cell sPecification	mm×N	14×1	14×1
	工作台速度 Table speed	m/min	5-25	5-25
前后结构 Y axis	前后手轮进刀(1格/1圈) hand wheel feed degree scale	mm	0.02/5	0.02/5
	前后自动进给 automatic feed	mm	0.1-8	0.1-8
	前后快速移动(50HZ/60HZ) Fast moving speed	mm/min	990 / 1190	990 / 1190
砂轮 Grinding wheel	砂轮尺寸 grinding wheel size max	mm	Φ180×12.5×31.75	Φ350×40×127
	砂轮转速(50HZ/60HZ) grinding wheel speed	R.P.M	2850 / 3360	1450 / 1740
上下结构 Z axis	上下手轮进刀(1格/1圈) hand wheel feed degree scale	mm	0.005/1	0.005/1
	上下快速移动速度 Fast moving speed	mm/min	230	230
马达 Motor	主轴马达 spindle motor	H×P	2×2	5×4
	上下驱动马达 the Z axis motor	W	150	150
	油压马达 hydraulic motor	H×P	2×6	2×6
	冲水马达 cooling motor	W	90	90
	前后驱动马达 the Y axis motor	W	80	80
尺寸 Size	机床外形尺寸(长×宽×高)Machine Tool Profile Size	mm	2000×1900×1810	2000×1900×1810
	重量 weight ( 约 )	kg	≈2200	≈2200



# PCA4080 Precision surface grinding machine

## AHR/AHD/NC/CNC



All-closed 4080



4080 with waterproof plate

The picture and specification is for your reference only, all is subject to material object.

参数表	规格parameter	Unit	PCA-4080
能力 Capacity	工作台面积 Table size(x*y)	mm	400×800
	左右最大移动量 X axis travel	mm	950
	前后最大移动量 Y axis travel	mm	460
	工作台面至主轴中心最大距离 Max center of wheel to table	mm	510
	工作台最大承受重量 Maximum load	kg	600
工作台Table X axis	工作台T型槽 Table T cell specification	mm×N	14×3
	工作台速度 Table speed	m/min	5-25
前后结构 Y axis	前后手轮进刀(1格/1圈) hand wheel feed degree scale	mm	0.02/5
	前后自动进给 automatic feed	mm	0.1-8
	前后快速移动(50HZ/60HZ) Fast moving speed	mm/min	990 / 1190
砂轮 Grinding wheel	砂轮尺寸 grinding wheel size max	mm	Φ400×20-50×127
	砂轮转速(50HZ/60HZ) grinding wheel speed	R.P.M	1450 / 1740
上下结构 Z axis	上下手轮进刀(1格/1圈) hand wheel feed degree scale	mm	0.005/1
	上下快速移动速度 Fast moving speed	mm/min	230
马达 Motor	主轴马达 spindle motor	H×P	7.5×4
	上下驱动马达 the Z axis motor	W	150
	油压马达 hydraulic motor	H×P	3×6
	冲水马达 cooling motor	W	90
	前后驱动马达 the Y axis motor	W	80
尺寸 Size	机床外形尺寸(长×宽×高) Machine Tool Profile Size	mm	2510x2150x1890
	重量 weight ( 约 )	kg	≈2600

# PCA40100 Precision surface grinding machine

## AHR/AHD/NC/CNC



All-closed 40100



40100 with waterproof plate

The picture and specification is for your reference only, all is subject to material object.

参数表	规格parameter	Unit	PCA-40100
能力 Capacity	工作台工作面积 Table size(x*y)	mm	400×1000
	左右最大移动量 X axis travel	mm	1200
	前后最大移动量 Y axis travel	mm	460
	工作面至主轴中心最大距离 Max center of wheel to table	mm	510
	工作台最大承受重量 Maximum load	kg	700
工作台Table X axis	工作台T型槽 Table T cell specification	mm×N	14×3
	工作台速度 Table speed	m/min	5-25
前后结构 Y axis	前后手轮进刀(1格/1圈) hand wheel feed degree scale	mm	0.02/5
	前后自动进给 automatic feed	mm	0.1-8
	前后快速移动(50HZ/60HZ) Fast moving speed	mm/min	990/1190
砂轮 Grinding wheel	砂轮尺寸 grinding wheel size max	mm	Φ400×20-50×127
	砂轮转速(50HZ/60HZ) grinding wheel speed	R.P.M	1450/1740
上下结构 Z axis	上下手轮进刀(1格/1圈) hand wheel feed degree scale	mm	0.005/1
	上下快速移动速度 Fast moving speed	mm/min	230
马达 Motor	主轴马达 spindle motor	H×P	7.5×4
	上下驱动马达 the Z axis motor	W	150
	油压马达 hydraulic motor	H×P	3×6
	冲水马达 cooling motor	W	90
	前后驱动马达 the Y axis motor	W	80
尺寸 Size	机床外形尺寸(长×宽×高)Machine Tool Profile Size	mm	2850×2150×1890
	重量 weight (约)	kg	≈2800

# PCA510 Precision surface grinding machine

## AHR/AHD/NC/CNC



- 1.Special for processing right angle of mold
- 2.Special for grinding V-slot

The picture and specification is for your reference only, all is subject to material object.

参数表	规格parameter	Unit	PCA-510
能力 Capacity	工作台面积 Table size(x*y)	mm	500×1000
	左右最大移动量 X axis travel	mm	1200
	前后最大移动量 Y axis travel	mm	560
	工作台面至主轴中心最大距离 Max center of wheel to table	mm	500
	工作台最大承受重量 Maximum load	kg	700
工作台Table X axis	工作台T型槽 Table T cell specification	mm×N	18×3
	工作台速度 Table speed	m/min	5-25
前后结构 Y axis	前后手轮进刀(1格/1圈) hand wheel feed degree scale	mm	0.02/5
	前后自动进给 automatic feed	mm	0.1-10
	前后快速移动(50HZ/60HZ) Fast moving speed	mm/min	990/1190
砂轮 Grinding wheel	砂轮尺寸 grinding wheel size max	mm	φ400×20-50×127
	砂轮转速(50HZ/60HZ) grinding wheel speed	R.P.M	1450/1740
上下结构 Z axis	上下手轮进刀(1格/1圈) hand wheel feed degree scale	mm	0.005/1
	上下快速移动速度 Fast moving speed	mm/min	230
马达 Motor	主轴马达 spindle motor	H×P	7.5×4
	上下驱动马达 the Z axis motor	W	150
	油压马达 hydraulic motor	H×P	3×6
	冲水马达 cooling motor	W	90
	前后驱动马达 the Y axis motor	W	80
尺寸 Size	机床外形尺寸(长×宽×高)Machine Tool Profile Size	mm	2930x2250x1890
	重量 weight ( 约 )	kg	≈3700



PCD50100 Precision surface grinding machine  
PCD50120 Precision surface grinding machine  
AHR/AHD/NC/CNC



50100 with waterproof plate



The picture and specification is for your reference only,  
all is subject to material object.

参数表	规格parameter	Unit	PCD-50100	PCD-50120
能力 Capacity	工作台工作面积 Table size(x*y)	mm	500×1000	500×1200
	左右最大移动量 X axis travel	mm	1250	1400
	前后最大移动量 Y axis travel	mm	570	570
	工作台面至主轴中心最大距离 Max center of wheel to table	mm	560	560
	工作台最大承受重量 Maximum load	kg	2200	2500
工作台Table X axis	工作台T型槽 Table T cell specification	mm×N	18×3	18×3
	工作台速度 Table speed	m/min	5-25	5-25
前后结构 Y axis	前后手轮进刀(1格/1圈) hand wheel feed degree scale	mm	0.02/5	0.02/5
	前后自动进给 automatic feed	mm	0.1-8	0.1-8
	前后快速移动(50HZ/60HZ) Fast moving speed	mm/min	990/1190	990/1190
砂轮 Grinding wheel	砂轮尺寸 grinding wheel size (max)	mm	Φ400×20-50×127	
	砂轮转速(50HZ/60HZ) grinding wheel speed	R.P.M	1450/1740	1450/1740
上下结构 Z axis	上下手轮进刀(1格/1圈) hand wheel feed degree scale	mm	0.005/0.2	0.005/0.2
	上下快速移动速度 Fast moving speed	mm/min	230	230
马达 Motor	主轴马达 spindle motor	H×P	7.5×4	7.5×4
	上下驱动马达 the Z axis motor	W	1/4×6	1/4×6
	油压马达 hydraulic motor	H×P	5×6	5×6
	冲水马达 cooling motor	W	90	90
	前后驱动马达 the Y axis motor	W	1/4×6	1/4×6
尺寸 Size	机床外形尺寸(长×宽×高)Machine Tool Profile Size	mm	3400x2600x2100	3500x2600x2100
	重量 weight ( 约 )	kg	≈5000	≈5300

# PCD60100 Precision surface grinding machine

# PCD60120 Precision surface grinding machine

## AHR/AHD/NC/CNC



The picture and specification is for your reference only, all is subject to material object.

参数表	规格parameter	Unit	PCD-60100	PCD-60120
能力 Capacity	工作台工作面积 Table size(x*y)	mm	600×1000	600×1200
	左右最大移动量 X axis travel	mm	1250	1400
	前后最大移动量 Y axis travel	mm	660	660
	工作台面至主轴中心最大距离 Max center of wheel to table	mm	560	560
	工作台最大承受重量 Maximum load	kg	2500	2500
工作台Table X axis	工作台T型槽 Table T cell specification	mm×N	18×3	18×3
	工作台速度 Table speed	m/min	5-25	5-25
前后结构 Y axis	前后手轮进刀(1格/1圈) hand wheel feed degree scale	mm	0.02/5	0.02/5
	前后自动进给 automatic feed	mm	0.1-8	0.1-8
	前后快速移动(50HZ/60HZ) Fast moving speed	mm/min	990/1190	990/1190
砂轮 Grinding wheel	砂轮尺寸 grinding wheel size (max)	mm	Φ400×20-50×127	
	砂轮转速(50HZ/60HZ) grinding wheel speed	R.P.M	1450/1740	1450/1740
上下结构 Z axis	上下手轮进刀(1格/1圈) hand wheel feed degree scale	mm	0.005/0.2	0.005/0.2
	上下快速移动速度 Fast moving speed	mm/min	230	230
马达 Motor	主轴马达 spindle motor	H×P	10×4	10×4
	上下驱动马达 the Z axis motor	W	1/4×6	1/4×6
	油压马达 hydraulic motor	H×P	5×6	5×6
	冲水马达 cooling motor	W	90	90
	前后驱动马达 the Y axis motor	W	1/4×6	1/4×6
尺寸 Size	机床外形尺寸(长×宽×高)Machine Tool Profile Size	mm	3400x2600x2100	3500x2600x2100
	重量 weight ( 约 )	kg	≈5500	≈5800

# PCD50150 Precision surface grinding machine

# PCD60150 Precision surface grinding machine

# PCD70150 Precision surface grinding machine

## AHR/AHD/NC/CNC



- 1.Special for processing right angle of mold
- 2.Special for grinding V-slot



The picture and specification is for your reference only, all is subject to material object.

参数表	规格parameter	Unit	PCD-50150	PCD-60150	PCD-70150
能力 Capacity	工作面积 Table size(x*y)	mm	500×1500	600×1500	700×1500
	左右最大移动量 X axis travel	mm	1700	1700	1700
	前后最大移动量 Y axis travel	mm	570	670	770
	工作台面至主轴中心最大距离 Max center of wheel to table	mm	560	560	560
	工作台最大承受重量 Maximum load	kg	2500	2500	2500
工作台Table X axis	工作台T型槽 Table T cell specification	mm×N	18×3	18×3	18×3
	工作台速度 Table speed	m/min	5-25	5-25	5-25
前后结构 Y axis	前后手轮进刀(1格/1圈) hand wheel feed degree scale	mm	0.02/5	0.02/5	0.02/5
	前后自动进给 automatic feed	mm	0.1-8	0.1-8	0.1-8
	前后快速移动(50HZ/60HZ) Fast moving speed	mm/min	990/1190	990/1190	990/1190
砂轮 Grinding wheel	砂轮尺寸 grinding wheel size max	mm	Φ400×20-50×127		
	砂轮转速(50HZ/60HZ) grinding wheel speed	R.PM	1450/1740	1450/1740	1450/1740
上下结构 Z axis	上下手轮进刀(1格/1圈) hand wheel feed degree scale	mm	0.005/0.2	0.005/0.2	0.005/0.2
	上下快速移动速度 Fast moving speed	mm/min	230	230	230
马达 Motor	主轴马达 spindle motor	H×P	10×4	10×4	10×4
	上下驱动马达 the Z axis motor	W	1/4×6	1/4×6	1/4×6
	油压马达 hydraulic motor	H×P	7.5×6	7.5×6	7.5×6
	冲水马达 cooling motor	W	90	90	90
	前后驱动马达 the Y axis motor	W	1/4×6	1/4×6	1/4×6
尺寸 Size	机床外形尺寸(长×宽×高)Machine Tool Profile Size	mm	4320x2600X2100	4320x2600X2100	4320x2600X2100
	重量 weight ( 约 )	kg	≈6200	≈6600	≈7000



# PCD80160 Precision surface grinding machine

# PCD80200 Precision surface grinding machine

## AHR/AHD/NC/CNC



80200 with waterproof plate



The picture and specification is for your reference only,  
all is subject to material object.

参数表	规格parameter	Unit	PCD-80160	PCD-80200
能力 Capacity	工作台工作面积 Table size(x*y)	mm	800×1600	800×2000
	左右最大移动量 X axis travel	mm	1800	2200
	前后最大移动量 Y axis travel	mm	870	870
	工作台面至主轴中心最大距离 Max center of wheel to table	mm	560	560
	工作台最大承受重量 Maximum load	kg	3000	3000
工作台Table X axis	工作台T型槽 Table T cell specification	mm×N	18×3	18×3
	工作台速度 Table speed	m/min	5-25	5-25
前后结构 Y axis	前后手轮进刀(1格/1圈) hand wheel feed degree scale	mm	0.02/5	0.02/5
	前后自动进给 automatic feed	mm	0.1-8	0.1-8
	前后快速移动(50HZ/60HZ) Fast moving speed	mm/min	990/1190	990/1190
砂轮 Grinding wheel	砂轮尺寸 grinding wheel size max	mm	Φ400×20-50×127	
	砂轮转速(50HZ/60HZ) grinding wheel speed	R.P.M	1450/1740	1450/1740
上下结构 Z axis	上下手轮进刀(1格/1圈) hand wheel feed degree scale	mm	0.005/0.2	0.005/0.2
	上下快速移动速度 Fast moving speed	mm/min	230	230
马达 Motor	主轴马达 spindle motor	H×P	10×4	10×4
	上下驱动马达 the Z axis motor	W	1/4×6	1/4×6
	油压马达 hydraulic motor	H×P	10×6	10×6
	冲水马达 cooling motor	W	90	90
	前后驱动马达 the Y axis motor	W	1/4×6	1/4×6
尺寸 Size	机床外形尺寸(长×宽×高)Machine Tool Profile Size	mm	5500×3050×2200	5500×3050×2200
	重量 weight ( 约 )	kg	≈9000	≈9600

# PCD90200 Precision surface grinding machine

# PCD100200 Precision surface grinding machine

## AHR/AHD/NC/CNC



The picture and specification is for your reference only, all is subject to material object.

参数表	规格parameter	Unit	PCD-90200	PCD-100200
能力 Capacity	工作台工作面积 Table size(x*y)	mm	900×2000	1000×2000
	左右最大移动量 X axis travel	mm	2300	2300
	前后最大移动量 Y axis travel	mm	970	1070
	工作台面至主轴中心最大距离 Max center of wheel to table	mm	560	560
	工作台最大承受重量 Maximum load	kg	4000	4000
工作台Table X axis	工作台T型槽 Table T cell specification	mm×N	18×3	18×3
	工作台速度 Table speed	m/min	5-25	5-25
前后结构 Y axis	前后手轮进刀(1格/1圈) hand wheel feed degree scale	mm	0.02/5	0.02/5
	前后自动进给 automatic feed	mm	0.1-8	0.1-8
	前后快速移动(50HZ/60HZ) Fast moving speed	mm/min	990/1190	990/1190
砂轮 Grinding wheel	砂轮尺寸 grinding wheel size max	mm	Φ400×20-50×127	
	砂轮转速(50HZ/60HZ) grinding wheel speed	R.P.M	1450/1740	1450/1740
上下结构 Z axis	上下手轮进刀(1格/1圈) hand wheel feed degree scale	mm	0.005/0.2	0.005/0.2
	上下快速移动速度 Fast moving speed	mm/min	230	230
马达 Motor	主轴马达 spindle motor	H×P	10×4	10×4
	上下驱动马达 the Z axis motor	W	1/2×6	1/2×6
	油压马达 hydraulic motor	H×P	10×6	10×6
	冲水马达 cooling motor	W	90	90
	前后驱动马达 the Y axis motor	W	1/4×6	1/4×6
尺寸 Size	机床外形尺寸(长×宽×高)Machine Tool Profile Size	mm	5500×3050×2200	5500×3250×2200
	重量 weight ( 约 )	kg	≈10500	≈11200

# PCD100250 Precision surface grinding machine

# PCD100300 Precision surface grinding machine

## AHR/AHD/NC/CNC



The picture and specification is for your reference only,  
all is subject to material object.

参数表	规格parameter	Unit	PCD-100250	PCD-100300
能力 Capacity	工作台工作面积 Table size(x*y)	mm	1000×2500	1000×3000
	左右最大移动量 X axis travel	mm	2800	3200
	前后最大移动量 Y axis travel	mm	1070	1070
	工作台面至主轴中心最大距离 Max center of wheel to table	mm	560	560
	工作台最大承受重量 Maximum load	kg	5000	5000
工作台Table X axis	工作台T型槽 Table T cell specification	mm×N	18×3	18×3
	工作台速度 Table speed	m/min	5-25	5-25
前后结构 Y axis	前后手轮进刀(1格/1圈) hand wheel feed degree scale	mm	0.02/5	0.02/5
	前后自动进给 automatic feed	mm	0.1-8	0.1-8
	前后快速移动(50HZ/60HZ) Fast moving speed	mm/min	990/1190	990/1190
砂轮 Grinding wheel	砂轮尺寸 grinding wheel size max	mm	Φ400×20-50×127	
	砂轮转速(50HZ/60HZ) grinding wheel speed	R.P.M	1450/1740	1450/1740
上下结构 Z axis	上下手轮进刀(1格/1圈) hand wheel feed degree scale	mm	0.005/0.2	0.005/0.2
	上下快速移动速度 Fast moving speed	mm/min	230	230
马达 Motor	主轴马达 spindle motor	H×P	10×4	10×4
	上下驱动马达 the Z axis motor	W	1/2×6	1/2×6
	油压马达 hydraulic motor	H×P	10×6	10×6
	冲水马达 cooling motor	W	90	90
	前后驱动马达 the Y axis motor	W	1/4×6	1/4×6
尺寸 Size	机床外形尺寸(长×宽×高)Machine Tool Profile Size	mm	6000×3250×2200	7500×3250×2200
	重量 weight ( 约 )	kg	≈12600	≈15000



PCA250CNC Precision surface grinding machine  
PCA3060CNC Precision surface grinding machine  
PCA4080CNC Precision surface grinding machine  
PCA60120CNC Precision surface grinding machine



## CNC series

The picture and specification is for your reference only,  
all is subject to material object.

# PCW3068NC Precision surface grinding machine

## PCW40100NC Precision surface grinding machine

### Machine features

- 1.All-closed dust proof(increase service life)
- 2.X axis driven by double oil cylinder (smooth movement, small vibration)
3. X axis inducted by electromagnetic.(low noise)
- 4.Independent hydraulic system (Reduction of hydraulic oil waste)
- 5.Controlled by PLC and directly entering process value (easy operation)
- 6.Independent lubrication circuit(avoid oil drip)
- 7.wear-resistant rubber on X,Y axis.(keep accuracy, increase service life)



The picture and specification is for your reference only, all is subject to material object.

参数表	规格parameter	Unit	PCW-3068	PCW-40100
能力 Capacity	工作台工作面积 Table size(x*y)	mm	300x680	400x1000
	左右最大移动量 X axis travel	mm	800	1120
	前后最大移动量 Y axis travel	mm	380	480
	工作台面至主轴中心最大距离 Max center of wheel to table	mm	540	540
	工作台最大承受重量 Maximum load	k9	600	800
工作台Table X axis	工作台T型槽 Table T cell specification	mm×N	14x3	14x3
	工作台速度 Table speed	m/min	5-25	5-25
前后结构 Y axis	前后自动进给 automatic feed	mm	0.05-15	0.05-15
	前后快速移动(50HZ/60HZ) Fast moving speed	mm/min	990/1190	990/1190
砂轮 Grinding wheel	砂轮尺寸 grinding wheel size max	mm	Φ350x40x127	
	砂轮转速(50HZ/60HZ) grinding wheel speed	R.P.M	1450/1740	1450/1740
上下结构 Z axis	上下自动进刀 hand wheel feed degree scale	mm	0.005-0.08	0.005-0.08
	上下快速移动速度 Fast moving speed	mm/min	230	230
马达 Motor	主轴马达 spindle motor	H×P	10x4	10x4
	上下伺服马达 the Z axis motor	W	1000	1000
	油压马达 hydraulic motor	H×P	3x6	3x6
	冲水马达 cooling motor	W	90	90
	前后伺服马达 the Y axis motor	W	1000	1000
尺寸 Size	机床外形尺寸(长×宽×高) Machine Tool Profile Size	mm	3050x1673x2095	3150x1673x2095
	重量 weight ( 约 )	kg	≈ 4200	≈ 4500

# PCW50100NC Precision surface grinding machine

## PCW63125NC Precision surface grinding machine

### Machine features

- 1.All-closed dust proof(increase service life)
- 2.X axis driven by double oil cylinder (smooth movement, small vibration)
3. X axis inducted by electromagnetic.(low noise)
- 4.Independent hydraulic system (Reduction of hydraulic oil waste)
- 5.Controlled by PLC and directly entering process value (easy operation)
- 6.Independent lubrication circuit(avoid oil drip)
- 7.wear-resistant rubber on X,Y axis.(keep accuracy, increase service life)



The picture and specification is for your reference only, all is subject to material object.

参数表	规格parameter	Unit	PCW-50100	PCW-63125
能力 Capacity	工作台工作面积 Table size(x*y)	mm	500x1000	630x1250
	左右最大移动量 X axis travel	mm	1120	1370
	前后最大移动量 Y axis travel	mm	580	710
	工作台面至主轴中心最大距离 Max center of wheel to table	mm	560	560
	工作台最大承受重量 Maximum load	kg	900	1000
工作台Table X axis	工作台T型槽 Table T cell specification	mm×N	14x3	14x3
	工作台速度 Table speed	m/min	5-25	5-25
前后结构 Y axis	前后自动进给 automatic feed	mm	0.05-15	0.05-15
	前后快速移动(50HZ/60HZ) Fast moving speed	mm/min	990/1190	990/1190
砂轮 Grinding wheel	砂轮尺寸 grinding wheel size max	mm	Φ400×20-50×127	
	砂轮转速(50HZ/60HZ) grinding wheel speed	R.P.M	1450/1740	1450/1740
上下结构 Z axis	上下自动进刀 hand wheel feed degree scale	mm	0.05-0.08	0.005-0.08
	上下快速移动速度 Fast moving speed	mm/min	230	230
马达 Motor	主轴马达 spindle motor	H×P	10x4	10x4
	上下伺服马达 the Z axis motor	W	1000	1000
	油压马达 hydraulic motor	H×P	5x6	5x6
	冲水马达 cooling motor	W	90	90
	前后伺服马达 the Y axis motor	W	1000	1000
尺寸 Size	机床外形尺寸(长×宽×高) Machine Tool Profile Size	mm	3500x2400x2100	3600x2715x2100
	重量 weight ( 约 )	kg	≈5000	≈5800



# PCLD80200NC Beam-type single-head gantry grinding machine

## PCLD90200NC Beam-type single-head gantry grinding machine



The picture and specification is for your reference only, all is subject to material object.

参数表	规格parameter	Unit	PCLD80200	PCLD90200
能力 Capacity	工作台工作面积 Table size(x*y)	mm	800x2000	900x2000
	左右最大移动量 X axis travel	mm	2200	2200
	工作台面至主轴中心最大距离 Max center of wheel to table	mm	620	620
	通过门柱最大距离 Max. Distance from worktable to beam	mm	1100	1200
工作台 Table	工作台最大承受重量 Maximum load	kg	5000	5000
	工作台速度 Table speed	m/min	5~28	5~28
	工作台T型槽Table T cell specification	mmxN	18*5	18*5
横磨头 Grinding head	砂轮尺寸 grinding wheel size max	mm	Φ400×20-50×127	
	主轴马达 spindle motor	HxP	15x4	15x4
	砂轮转速(50HZ) Grinding wheel speed	R.P.M	1450	1450
尺寸 Size	机器高度 height of machine (运动高度Motion Height)	mm	≈3500	≈3500
	占地面积 floor space (长x宽)	mm	5900x3000	5900x3050
	重量 weight	kg	≈15000	≈15500

PCLD100200NC Beam-type single-head gantry grinding machine  
PCLD120200NC Beam-type single-head gantry grinding machine



The picture and specification is for your reference only,  
all is subject to material object.

参数表	规格parameter	Unit	PCLD100200	PCLD120200
能力 Capacity	工作台工作面积 Table size(x*y)	mm	1000x2000	1200x2000
	左右最大移动量 X axis travel	mm	2200	2200
	工作台面至主轴中心最大距离 Max center of wheel to table	mm	620	620
	通过门柱最大距离 Max. Distance from worktable to beam	mm	1300	1500
工作台 Table	工作台最大承受重量 Maximum load	kg	5000	5000
	工作台速度 Table speed	m/min	5~28	5~28
	工作台T型槽Table T cell specification	mmxN	18*5	18*5
横磨头 Grinding head	砂轮尺寸 grinding wheel size max	mm	Φ500×Φ203×50-75	
	主轴马达 spindle motor	HxP	25x4	25x4
	砂轮转速(50HZ) Grinding wheel speed	R.P.M	1450	1450
尺寸 Size	机器高度 height of machine (运动高度Motion Height)	mm	≈3500	≈3500
	占地面积 floor space (长x宽)	mm	5900x3050	5900x3100
	重量 weight	kg	≈16000	≈16500

PCLD140200NC Beam-type single-head gantry grinding machine

PCLD150200NC Beam-type single-head gantry grinding machine



The picture and specification is for your reference only, all is subject to material object.

参数表	规格parameter	Unit	PCLD140200	PCLD150200
能力 Capacity	工作台工作面积 Table size(x*y)	mm	1400x2000	1500x2000
	左右最大移动量 X axis travel	mm	2200	2200
	工作台面至主轴中心最大距离 Max center of wheel to table	mm	620	620
	通过门柱最大距离 Max. Distance from worktable to beam	mm	1700	1800
工作台 Table	工作台最大承受重量 Maximum load	kg	5500	5500
	工作台速度 Table speed	m/min	5~28	5~28
	工作台T型槽Table T cell specification	mmxN	18*6	18*6
横磨头 Grinding head	砂轮尺寸 grinding wheel size max	mm	Φ500×Φ203×50-75	
	主轴马达 spindle motor	HxP	25x4	25x4
	砂轮转速(50HZ) Grinding wheel speed	R.P.M	1450	1450
尺寸 Size	机器高度 height of machine (运动高度Motion Height)	mm	≈3600	≈3600
	占地面积 floor space (长x宽)	mm	5900x3500	5900x3500
	重量 weight	kg	≈21000	≈22000

PCLD120250NC Beam-type single-head gantry grinding machine  
PCLD150250NC Beam-type single-head gantry grinding machine



The picture and specification is for your reference only,  
all is subject to material object.

参数表	规格parameter	Unit	PCLD120250	PCLD150250
能力 Capacity	工作台工作面积 Table size(x*y)	mm	1200x2500	1500x2500
	左右最大移动量 X axis travel	mm	2700	2700
	工作台面至主轴中心最大距离 Max center of wheel to table	mm	670	670
	通过门柱最大距离 Max. Distance from worktable to beam	mm	1500	1800
工作台 Table	工作台最大承受重量 Maximum load	kg	6000	6000
	工作台速度 Table speed	m/min	5~28	5~28
	工作台T型槽Table T cell specification	mmxN	18*4	18*6
横磨头 Grinding head	砂轮尺寸 grinding wheel size max	mm	Φ500×Φ203×50-75	
	主轴马达 spindle motor	HxP	25x4	25x4
	砂轮转速(50HZ) Grinding wheel speed	R.P.M	1300	1300
尺寸 Size	机器高度 height of machine (运动高度Motion Height)	mm	≈3600	≈3600
	占地面积 floor space (长x宽)	mm	6720x3300	6720x3500
	重量 weight	kg	≈22000	≈23000



PCLD120300NC Beam-type single-head gantry grinding machine

PCLD150300NC Beam-type single-head gantry grinding machine



The picture and specification is for your reference only,  
all is subject to material object.

参数表	规格parameter	Unit	PCLD120300	PCLD150300
能力 Capacity	工作台工作面积 Table size(x*y)	mm	1200x3000	1500x3000
	左右最大移动量 X axis travel	mm	3200	3200
	工作台面至主轴中心最大距离 Max center of wheel to table	mm	670	670
	通过门柱最大距离 Max. Distance from worktable to beam	mm	1500	1800
工作台 Table	工作台最大承受重量 Maximum load	kg	6500	6500
	工作台速度 Table speed	m/min	5~28	5~28
	工作台T型槽Table T cell specification	mmxN	18*5	18*6
横磨头 Grinding head	砂轮尺寸 grinding wheel size max	mm	Φ500×Φ203×50-75	
	主轴马达 spindle motor	HxP	25x4	25x4
	砂轮转速(50HZ) Grinding wheel speed	R.P.M	1300	1300
尺寸 Size	机器高度 height of machine (运动高度Motion Height)	mm	≈3700	≈3700
	占地面积 floor space (长x宽)	mm	8520x3400	8520x3400
	重量 weight	kg	≈24000	≈25000

PCLD180300NC Beam-type single-head gantry grinding machine  
PCLD200300NC Beam-type single-head gantry grinding machine



The picture and specification is for your reference only,  
all is subject to material object.

参数表	规格parameter	Unit	PCLD180300	PCLD200300
能力 Capacity	工作台工作面积 Table size(x*y)	mm	1800x3000	2000x3000
	左右最大移动量 X axis travel	mm	3200	3200
	工作台面至主轴中心最大距离 Max center of wheel to table	mm	670	670
	通过门柱最大距离 Max. Distance from worktable to beam	mm	2100	2300
工作台 Table	工作台最大承受重量 Maximum load	kg	7000	7000
	工作台速度 Table speed	m/min	5~28	5~28
	工作台T型槽Table T cell specification	mmxN	18*8	18*8
横磨头 Grinding head	砂轮尺寸 grinding wheel size max	mm	Φ500×Φ203×50-75	
	主轴马达 spindle motor	HxP	25x4	25x4
	砂轮转速(50HZ) Grinding wheel speed	R.P.M	1300	1300
尺寸 Size	机器高度 height of machine (运动高度Motion Height)	mm	≈3700	≈3700
	占地面积 floor space (长x宽)	mm	8300x4100	8300x4200
	重量 weight	kg	≈32000	≈35000

# PCLD200400NC Beam-type single-head gantry grinding machine

## PCLD200600NC Beam-type single-head gantry grinding machine



The picture and specification is for your reference only,  
all is subject to material object.

参数表	规格parameter	Unit	PCLD200400	PCLD200600
能力 Capacity	工作台工作面积 Table size(x*y)	mm	2000x4000	2000x6000
	左右最大移动量 X axis travel	mm	4200	6200
	工作台面至主轴中心最大距离 Max center of wheel to table	mm	670	670
	通过门柱最大距离 Max. Distance from worktable to beam	mm	2300	2300
工作台 Table	工作台最大承受重量 Maximum load	kg	8000	9000
	工作台速度 Table speed	m/min	5~28	5~28
	工作台T型槽Table T cell specification	mmxN	18*8	18*8
横磨头 Grinding head	砂轮尺寸 grinding wheel size max	mm	Φ500×Φ203×50-75	
	主轴马达 spindle motor	HxP	25x4	25x4
	砂轮转速(50HZ) Grinding wheel speed	R.P.M	1300	1300
尺寸 Size	机器高度 height of machine (运动高度Motion Height)	mm	≈4200	≈4200
	占地面积 floor space (长x宽)	mm	12000x4400	15000x4400
	重量 weight	kg	≈43000	≈58000

# PCLD200800NC Beam-type single-head gantry grinding machine

## PCLD250800NC Beam-type single-head gantry grinding machine



The picture and specification is for your reference only, all is subject to material object.

参数表	规格parameter	Unit	PCLD200800	PCLD250800
能力 Capacity	工作台工作面积 Table size(x*y)	mm	2000x8000	2500x8000
	左右最大移动量 X axis travel	mm	8200	8200
	工作台面至主轴中心最大距离 Max center of wheel to table	mm	670	670
	通过门柱最大距离 Max. Distance from worktable to beam	mm	2300	2800
工作台 Table	工作台最大承受重量 Maximum load	kg	10000	10000
	工作台速度 Table speed	m/min	5~28	5~28
	工作台T型槽Table T cell specification	mmxN	18*8	18*10
横磨头 Grinding head	砂轮尺寸 grinding wheel size max	mm	Φ500×Φ203×50-75	
	主轴马达 spindle motor	HXP	25x4	25x4
	砂轮转速(50HZ) Grinding wheel speed	R.P.M	1300	1300
尺寸 Size	机器高度 height of machine (运动高度Motion Height)	mm	≈4200	≈4200
	占地面积 floor space (长x宽)	mm	18100x4400	18100x4800
	重量 weight	kg	≈68000	≈78000



PCLXM100200NC Beam-type gantry milling and grinding machine  
PCLXM120200NC Beam-type gantry milling and grinding machine  
PCLXM140200NC Beam-type gantry milling and grinding machine  
PCLXM150200NC Beam-type gantry milling and grinding machine



The picture and specification is for your reference only, all is subject to material object.

参数表	规格parameter	Unit	100200/120200NC	140200/150200NC
能力 Capacity	工作台面积 Table size(x*y)	mm	1000/1200x2000	1400/1500x2000
	左右最大移动量 X axis travel	mm	1400/2200	1700/2200
	工作台面至主轴中心最大距离 Max center of wheel to table	mm	620	620
	通过门柱最大距离 Max. Distance from worktable to beam	mm	1300/1500	1700/1800
工作台 Table	工作台最大承受重量 Maximum load	kg	5000	5500
	工作台速度 Table speed	m/min	5~25	5~25
	工作台T型槽Table T cell specification	mmxN	18*5	18*6
横磨头 Grinding head	砂轮尺寸 grinding wheel size max	mm	Φ500×Φ203×50-75	
	主轴马达 spindle motor	HxP	20x4	20x4
	砂轮转速(50HZ) Grinding wheel speed	R.P.M	1450	1450
立式铣头 Vertical milling head	刀盘尺寸 Tool Size	mm	BT50-200	
	马达 motor	HxP	10*4	10*4
尺寸 Size	机器高度 height of machine (运动高度Motion Height)	mm	≈3500	≈3500
	占地面积 floor space (长x宽)	mm	5900x3850	5900x4300
	重量 weight	kg	≈24000/≈24500	≈26000/≈27000

该机械规格随品质提高会有所变更，对此恕不通知！/The mechanical specifications are subject to change with the increase in quality!

PCLXM120250NC Beam-type gantry milling and grinding machine

PCLXM150250NC Beam-type gantry milling and grinding machine



The picture and specification is for your reference only, all is subject to material object.

参数表	规格parameter	Unit	120250/150250NC
能力 Capacity	工作台工作面积 Table size(x*y)	mm	1200/1500x2500
	左右最大移动量 X axis travel	mm	2700
	工作台面至主轴中心最大距离 Max center of wheel to table	mm	670
	通过门柱最大距离 Max. Distance from worktable to beam	mm	1500/1800
工作台 Table	工作台最大承受重量 Maximum load	kg	6000
	工作台速度 Table speed	m/min	5~25
	工作台T型槽Table T cell specification	mmxN	18*4/18*6
横磨头 Grinding head	砂轮尺寸 grinding wheel size max	mm	Φ500×Φ203×50-75
	主轴马达 spindle motor	H×P	20x4
	砂轮转速(50HZ) Grinding wheel speed	R.P.M	1450
立式铣头 Vertical milling head	刀盘尺寸 Tool size	mm	BT50-200
	马达 motor	H×P	10*4
尺寸 Size	机器高度 height of machine (运动高度Motion Height)	mm	≈3600
	占地面积 floor space (长x宽)	mm	6720x4100/4300
	重量 weight	kg	≈27000/≈28000

该机械规格随品质提高会有所变更，对此恕不通知！/The mechanical specifications are subject to change with the increase in quality!

PCLXM100300NC Beam-type gantry milling and grinding machine  
PCLXM150300NC Beam-type gantry milling and grinding machine  
PCLXM180300NC Beam-type gantry milling and grinding machine  
PCLXM200300NC Beam-type gantry milling and grinding machine



The picture and specification is for your reference only, all is subject to material object.

参数表	规格parameter	Unit	120300/150300NC	180300/200300NC
能力 Capacity	工作台面积 Table size(x*y)	mm	1200/1500x3000	1800/2000x3000
	左右最大移动量 X axis travel	mm	1700/3200	1700/3200
	工作台面至主轴中心最大距离 Max center of wheel to table	mm	670	670
	通过门柱最大距离 Max. Distance from worktable to beam	mm	1500/1800	2100/2300
工作台 Table	工作台最大承受重量 Maximum load	kg	6500	7000
	工作台速度 Table speed	m/min	5~25	5~25
	工作台T型槽Table T cell specification	mmxN	18*5/18*6	18*8
横磨头 Grinding head	砂轮尺寸 grinding wheel size max	mm	Φ500×Φ203×50-75	
	主轴马达 spindle motor	HxP	25x4	25x4
	砂轮转速(50HZ) Grinding wheel speed	R.P.M	1300	1300
立式铣头 Vertical milling head	刀盘尺寸 Tool size	mm	BT50-200	
	马达 motor	HxP	10*4	10*4
尺寸 Size	机器高度 height of machine (运动高度Motion Height)	mm	3700	~3700
	占地面积 floor space (长x宽)	mm	8520x4300	8300x5100
	重量 weight	kg	~29000/~30000	~37000/~40000

该机械规格随品质提高会有所变更，对此恕不通知！/The mechanical specifications are subject to change with the increase in quality!

PCLS80200NC Beam-type double-head gantry rail grinding machine  
PCLS90200NC Beam-type double-head gantry rail grinding machine  
PCLS100200NC Beam-type double-head gantry rail grinding machine  
PCLS120200NC Beam-type double-head gantry rail grinding machine



The picture and specification is for your reference only,  
all is subject to material object.

参数表	规格parameter	Unit	80200/90200NC	100200/120200NC
能力 Capacity	工作台工作面积 Table size(x*y)	mm	800/900x2000	1000/1200x2000
	左右最大移动量 X axis travel	mm	1100/2200	1400/2200
	工作台面至主轴中心最大距离 Max center of wheel to table	mm	620	620
	通过门柱最大距离 Max. Distance from worktable to beam	mm	1100/1200	1300/1500
工作台 Table	工作台最大承受重量 Maximum load	kg	5000	5000
	工作台速度 Table speed	m/min	5~25	5~25
	工作台T型槽Table T cell specification	mmxN	18*5	18*5
横磨头 Grinding head	砂轮尺寸 grinding wheel size max	mm	Φ400×20-50×127	Φ500×Φ203×50-75
	主轴马达 spindle motor	HXP	15x4	15x4
	砂轮转速(50HZ) Grinding wheel speed	R.P.M	1450	1450
角度头 Angular head	砂轮尺寸 Grinding wheel size	mm	350*127*40	
	旋转角度 Rotation angle	度	左90/右90	
	主轴马达 spindle motor	HXP	7.5*4	7.5*4
	变频正反转(50HZ) ( 选配 ) Inverter motor reversing speed (optional)	R.P.M	0~1500	0~1500
尺寸 Size	机器高度 height of machine (运动高度Motion Height)	mm	≈3500	≈3500
	占地面积 floor space (长x宽)	mm	5900x3800	5900x3850
	重量 weight	kg	≈23000/≈23500	≈24000/≈24500

该机械规格随品质提高会有所变更，对此恕不通知！/The mechanical specifications are subject to change with the increase in quality!



PCLS140200NC Beam-type double-head gantry rail grinding machine  
PCLS150200NC Beam-type double-head gantry rail grinding machine  
PCLS120250NC Beam-type double-head gantry rail grinding machine  
PCLS150250NC Beam-type double-head gantry rail grinding machine



The picture and specification is for your reference only, all is subject to material object.

参数表	规格parameter	Unit	140200/150200NC	120250/150250NC
能力 Capacity	工作台工作面积 Table size(x*y)	mm	1400/1500x2000	1200/1500x2500
	左右最大移动量 X axis travel	mm	2200	2700
	工作台面至主轴中心最大距离 Max center of wheel to table	mm	670	670
	通过门柱最大距离 Max. Distance from worktable to beam	mm	1700/1800	1500/1800
工作台 Table	工作台最大承受重量 Maximum load	kg	5500	6000
	工作台速度 Table speed	m/min	5~28	5~28
	工作台T型槽Table T cell specification	mmxN	18*6	18*4/18*6
横磨头 Grinding head	砂轮尺寸 grinding wheel size max	mm	Φ500×Φ203×50-75	
	主轴马达 spindle motor	HXP	15x4	15x4
	砂轮转速(50HZ) Grinding wheel speed	R.P.M	1450	1450
角度头 Angular head	砂轮尺寸 Grinding wheel size	mm	350*127*40	
	旋转角度 Rotation angle	度	左90/右90	
	主轴马达 spindle motor	HXP	7.5*4	7.5*4
	变频正反转(50HZ) (选配) Inverter motor reversing speed (optional)	R.P.M	0~1500	0~1500
尺寸 Size	机器高度 height of machine (运动高度Motion Height)	mm	≈3600	≈3600
	占地面积 floor space (长x宽)	mm	5900x4300	6720x4100/4300
	重量 weight	kg	≈26000/≈27000	≈27000/≈28000

该机械规格随品质提高会有所变更，对此恕不通知！/The mechanical specifications are subject to change with the increase in quality!

PCLS120300NC Beam-type double-head gantry rail grinding machine  
PCLS150300NC Beam-type double-head gantry rail grinding machine  
PCLS180300NC Beam-type double-head gantry rail grinding machine  
PCLS200300NC Beam-type double-head gantry rail grinding machine



The picture and specification is for your reference only, all is subject to material object.

参数表	规格parameter	Unit	120300/150300NC	180300/200300NC
能力 Capacity	工作台工作面积 Table size(x*y)	mm	1200/1500x3000	1800/2000x3000
	左右最大移动量 X axis travel	mm	3200	3200
	工作台面至主轴中心最大距离 Max center of wheel to table	mm	670	670
	通过门柱最大距离 Max. Distance from worktable to beam	mm	1500/1800	2100/2300
工作台 Table	工作台最大承受重量 Maximum load	kg	6500	7000
	工作台速度 Table speed	m/min	5~25	5~25
	工作台T型槽Table T cell specification	mmxN	18*5/18*6	18*8
横磨头 Grinding head	砂轮尺寸 grinding wheel size max	mm	Φ500×Φ203×50-75	
	主轴马达 spindle motor	HXP	25x4	25x4
	砂轮转速(50HZ) Grinding wheel speed	R.P.M	1300	1300
角度头 Angular head	砂轮尺寸 Grinding wheel size	mm	350*127*40	
	旋转角度 Rotation angle	度	左90/右90	
	主轴马达 spindle motor	HXP	7.5*4	7.5*4
	变频正反转(50HZ) (选配) Inverter motor reversing speed (optional)	R.P.M	0~1500	0~1500
尺寸 Size	机器高度 height of machine (运动高度Motion Height)	mm	≈3700	≈3700
	占地面积 floor space (长x宽)	mm	8520x4300	8300x5100
	重量 weight	kg	≈29000/≈30000	≈37000/≈40000

该机械规格随品质提高会有所变更，对此恕不通知！/The mechanical specifications are subject to change with the increase in quality!

PCLS200400NC Beam-type double-head gantry rail grinding machine  
PCLS200600NC Beam-type double-head gantry rail grinding machine  
PCLS200800NC Beam-type double-head gantry rail grinding machine  
PCLS250800NC Beam-type double-head gantry rail grinding machine



The picture and specification is for your reference only,  
all is subject to material object.

参数表	规格parameter	Unit	200400/200600NC	200800/250800NC
能力 Capacity	工作台工作面积 Table size(x*y)	mm	2000x4000/6000	2000/2500x8000
	左右最大移动量 X axis travel	mm	4200/6200	8200
	工作台面至主轴中心最大距离 Max center of wheel to table	mm	670	670
	通过门柱最大距离 Max. Distance from worktable to beam	mm	2300	2300/2800
工作台 Table	工作台最大承受重量 Maximum load	kg	8000/9000	10000
	工作台速度 Table speed	m/min	5~25	5~25
	工作台T型槽Table T cell specification	mmxN	18*8	18*8/18*10
横磨头 Grinding head	砂轮尺寸 grinding wheel size max	mm	Φ500×Φ203×50-75	
	主轴马达 spindle motor	HXP	25x4	25x4
	砂轮转速(50HZ) Grinding wheel speed	R.P.M	1300	1300
角度头 Angular head	砂轮尺寸Grinding wheel size	mm	350*127*40	
	旋转角度 Rotation angle	度	左90/右90	
	主轴马达 spindle motor	HXP	7.5*4	7.5*4
	变频正反转(50HZ) ( 选配 ) Inverter motor reversing speed (optional)	R.P.M	0~1500	0~1500
尺寸 Size	机器高度 height of machine (运动高度Motion Height)	mm	≈4200	≈4200
	占地面积 floor space (长x宽)	mm	12000/15000x5000	18100x5000
	重量 weight	kg	≈48000/≈63000	≈73000/≈83000

该机械规格随品质提高会有所变更，对此恕不通知！/The mechanical specifications are subject to change with the increase in quality!





Processing workshop of large gantry grinding machine    Processing workshop of large gantry milling machine



Processing workshop of spare parts

Workshop of scraping



Assembly workshop of gantry grinding machine

Assembly workshop of move column grinding machine



Assembly workshop of CNC grinding machine

Assembly workshop of saddle grinding machine